

# ◀ The Summitt Family Quarterly ▶

Volume 9, Issue 4

January 2004

## From The Editor

First, a note of apology again. This is the January issue but it doesn't look like it will make the mail until February. My schedule has been so full lately that it has just been impossible for me to find the time to work on this. I was in Dallas for a week this month and will be in India from February 19th to March 6. I just finished another book project and it should be in the book stores by April at the latest I am told. Plus, I'm going to be a grandfather again. My health insurance company has assigned me a physical therapist for my diabetes who calls me regularly nagging me about my lack of exercise. She asked how she could help me exercise more and I told her to add more hours to the day. She didn't think it was funny.

Welcome to the final issue of our ninth year of publication. Yes, the April issue will be the first issue of our tenth year. In some ways it doesn't seem like it's possible that it was only nine years ago that Mary and I started this. I remember sending out the first issue to a few of my relatives with the note that if we didn't get ten people interested enough in it to help defray the cost it would be the only issue. We got exactly ten people to subscribe.

It has never been about the money. During the past nine years Mary and I have attended one family reunion and hosted another

(Continued on page 2)

## The Summitt Family Quarterly Cardwell Cemetery Project

As many of you who have been receiving the Quarterly over the past year or so know one of my pet projects is a Web representation of the Cardwell Cemetery. The Web representation is located at <http://www.summittfamilyquarterly.org/CardwellCemetery/Cemetery1.php>. Over the past two issues I have begun publishing the information I have starting with Section #4. I have now entered over five hundred gravesites from Section #4. As noted previously, some of the information used in this project comes from the document *Cardwell: Then and Now; 1894-1994* published by the Cardwell Cotton Festival Committee, 1994. You can find a few excerpts from this document starting on page 2. Also, if you are interested in supporting the Cardwell Cemetery or the Cockrum

(Continued on page 3)

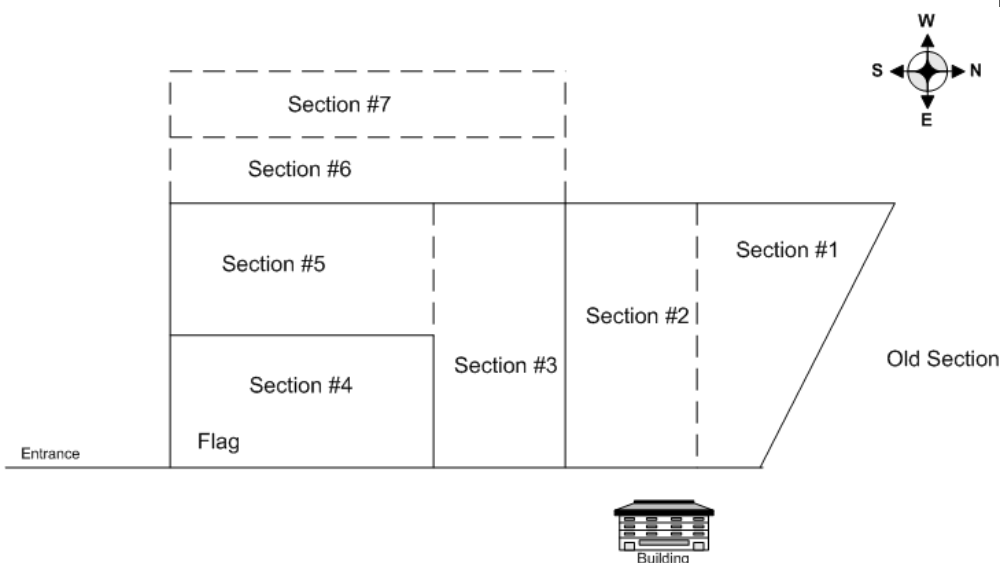

### Also In This Issue

Cardwell, Missouri map	Page 2
1930 Census for Dunklin County	Page 8
Buffalo Township, Missouri	Page 15
Search for new Editor/Publisher	Page 1

## Cardwell, Missouri (original layout of the town)

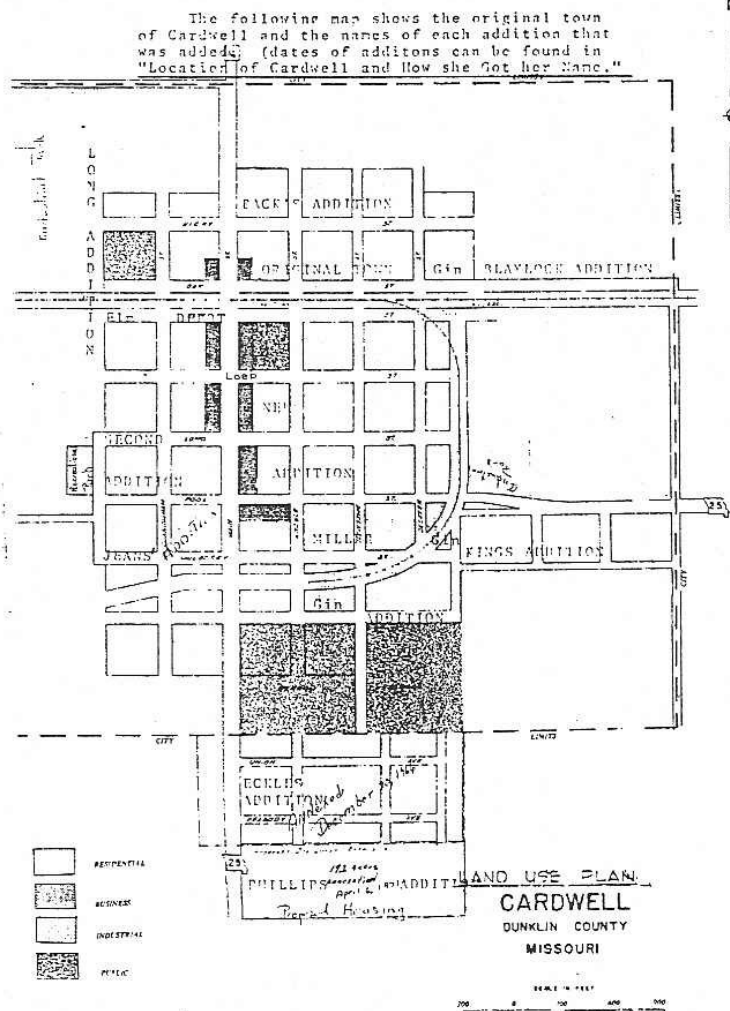

(Continued from page 1)

in Cardwell, Missouri and I have attended one reunion in North Carolina. I wish I could have attended more. We started out with the plan to hold reunions in the locations where Summitt(t)s settled and we started with Johan Franz in North Carolina but then something happened and we didn't follow through with Christian in Indiana for some reason. I guess I'm guilty of not following through on it like I should have.

In any event, during the past nine years I have had the opportunity to correspond with many of my close and distant relatives, with whom some of which I feel like I have developed a deep and lasting friendship. Of course there are those who consider my occasional emails spam, and those who get angry when their name is mentioned in the newsletter or on the Web site. And then there are those two individuals, one an extremely distant relative who thinks that I spend too much of the newsletter discussing my immediate family, and the other a much closer relative who thinks that I spend too

(Continued on page 7)

### EMAIL received

**Subject:** Re: Mrs. Williford  
**Date:** Mon, 19 Jan 2004 10:02:49 -0600  
**From:** G. G. Summitt <jacktex@airmail.net>  
**To:** Paul Moody Summitt <psummitt@summittnewmedia.com>

Mrs. LaRue Summitt Williford has left Houston and is now in a nursing home in New Braunfels, Texas. She is 96 and bed ridden.

As you know we all owe her a debt of gratitude for being the first to make the connection to Johannes Frantz Sammet. With this connection she was able to apply to the DAR and was accepted. My Daughter, Lea Ann Summitt, has tied on to Mrs. Williford's number and is a member of the DAR in Waco, Texas.

Her address now is: Mrs LaRue Williford  
2590 Route 337 North  
New Braunfels, Texas 78130

Best wishes,  
Granville G. (Jack) Summitt

**The Summitt  
Family Quarterly**  
Published by  
**Summitt New Media**  
**Volume 9 Issue 4**  
**January 2004**

Publisher - Mary J. Summitt  
Editor - Paul M. Summitt

312 Proctor Drive  
Columbia, MO 65202  
(573) 268-7209

www  
.summittfamilyquarterly  
.com

(Continued from page 1)

Cemetery, send your donations to: Cardwell Cemetery Association, P.O. Box 488, Cardwell, Missouri 63829.

S	R	P	Pre	First	Middle	Last	Suf	DOB	DOD	Comment
4	2	9		Betty	Jean	Chatham	Summitt	1/29/1930		"Married C. E. ""Bud"" Summitt Aug. 17, 1950; father of Kathie, Randall, and Cindy"
4	2	10		Randall Eugene		Summitt		5/21/1954	1/16/1992	"Husband of Leslie Annette Wilkins Summitt; Married Donna Traywick Summitt Dec 7, 1984; Father of Aaron and Natasha"
4	2	11		Donna	Traywick	Summitt		8/8/1959		"Married Randall Eugene Summitt Dec 7, 1984. Mother of Natasha"
4	2	12		Larry	A.	Gist		2/8/1937	9/23/1993	"Husband of Mary Lou Gist; Father of Donna, Brandon, and Angela"
4	2	13		Mary	Lou	Gist		5/14/1938		"Wife of Larry A. Gist; Father of Donna, Brandon, and Angela"
4	2	14		Joseph	A.	Gist		1898-02-05	8/5/1950	
4	2	15		Nioba	Yancy	Gist		2/26/1900	9/25/1991	
4	2	16		Lela	Mae	Moss		8/3/1909	7/13/1964	
4	2	17		Corbit	B.	Myracle		4/30/1913		
4	2	18		Irene	S.	Myracle		5/31/1913		
4	2	19		Beauford		Myracle		2/19/1942	6/27/1950	Son of Corbit and Irene Myracle
4	2	20		Lancie	E.	Montgomery		8/5/1901	5/27/1990	
4	2	21		Joseph	W.	Montgomery		3/18/1914	4/17/1987	
4	2	22		Emma	L.	Montgomery		3/17/1914		
4	2	23		Boyd		Hamlett		6/7/1904	10/26/1976	
4	2	24		J.	H.	Montgomery		1874-05-08	6/14/1957	""Uncle John""
4	2	25		Nancy		Montgomery		1869-04-28	1/26/1956	Wife of J. H. Montgomery
4	2	26		Tonya	Jean	Drope-Martineze		4/15/1958	6/8/1990	Adopted granddaughter of Winford and Virginia Drope
4	2	27		Virginia	F.	Drope		6/22/1924		"Wife of C. W. Drope; Mother of Shirley, Phyllis, Roger, Linda, Bambie, Susan, and Tonya"
4	2	28		Charles	Wink	Drope		11/11/1922	11/30/1986	"Husband of Virginia F. Drope; Father of Shirley, Phyllis, Roger, Linda, Bambie, Susan, and Tonya"
4	2	29		Linda	Kay	Drope		6/13/1944	4/15/1948	Daughter of C.W. and V.F. Drope
4	2	30		Albert	Adam	Conrad		1893-02-26	5/18/1951	MO PVT QM Corps World War I
4	2	31		Arlie	V.	Conrad		12/20/1917	7/27/1944	MO Staff SGT 330 INF 35 INF DIV WWII
4	2	32		Zora		Conrad		1889-01-29	5/18/1973	
4	2	33		James	F.	Conrad		1887-03-04	4/22/1965	
4	2	34		Imogene	Wycoff	Chase		11/5/1924	3/24/1982	
4	2	35		Hattie		Wycoff		1891-02-05	12/30/1964	
4	2	36		Elmer		Wycoff		1874-07-28	3/27/1949	
4	2	37		Annie	May	Ladd		1890-07-17	8/26/1980	"Married to James Fountain Ladd; Mother of Wayver, Edith, Debs, Naomi, and Hester Mai"
4	2	38		Jame	Fountain	Ladd		1891-10-17	11/19/1958	"Married to Annie May Ladd; Father of Wayver, Edith, Debs, Naomi, and Hester Mai"
4	2	39		Debs		Ladd		12/2/1914	3/16/1961	
4	2	40		Gilbert	Lee	Brewer		7/10/1917	9/4/1992	
4	2	41		Oleda	Buck	Brewer		12/12/1920		
4	2	42		Wayver		Brewer		12/8/1910	5/27/1994	

(Continued on page 4)

**The Summitt Family Quarterly**

*(Continued from page 3)*

<b>S</b>	<b>R</b>	<b>P</b>	<b>Pre</b>	<b>First</b>	<b>Middle</b>	<b>Last</b>	<b>Suf</b>	<b>DOB</b>	<b>DOD</b>	<b>Comment</b>
4 2	43			Onie	A.	Brewer		4/21/1905	8/28/1969	Husband of Wayver; Father of Jerry
4 2	44			Herman	S.	Loyd		8/3/1907		
4 2	45			Katie	B.	Loyd		8/30/1908		"Married Herman S. Loyd; Mother of Joe, Betty, Norma, and Jack"
4 2	46			James	H.	Loyd	L	1879-08-30	11/21/1961	
4 2	47			Cora	L.	Loyd		1879-06-01	12/23/1954	
4 2	48			Terry	Lynn	Yopp		1960-05-00	1960-05-00	Son of James L. and Bonnie Yopp
4 2	49			Fannie	Sue	Hosman		7/7/1909	3/3/1992	"Married Floyd L. Hosman; Mother of Dwight, Ray, and Bonnie"
4 2	50			Floyd	L.	Hosman		7/7/1903	9/21/1984	"Married Fannie Sue. Hosman; Father of Dwight, Ray, and Bonnie"
4 2	51			George	W.	Hyde		1886-11-17	8/20/1966	
4 2	52			Betty		Hyde		1888-07-20	9/8/1992	
4 2	53			Ines	Ellen	Bush		3/14/1911	3/8/1986	"Married John Gilbert Bush; Mother of Violet, Frank, George, and Edward"
4 2	54			John	Gilbert	Bush		1898-03-04	8/28/1969	"Married Ines Ellen Bush; Father of Violet, Frank, George, and Edward"
4 2	55			Albert	W. "Wash"	Allen		1/16/1908	10/18/1941	"Married Flora Allen White Allen; father of Irene, W.T., Carl, A.G. and Don"
4 2	56			Flora	Allen White	Allen		1/1/1910	6/22/1992	"Married Albert W. ""Wash"" Allen; Mother of Irene, W.T., Carl, A.G. and Don"
4 2	57			Hardin	K.	White		9/1/1908	9/16/1979	
4 2	58			J.	W.	Haynes		1877-01-24	5/3/1944	
4 3	1			Henry	M.	Fairchild		8/20/1912	12/27/1974	"Married Helen L. Fairchild May 22, 1944"
4 3	2			Helen	L.	Fairchild		1/4/1920	11/18/1973	"Married Henry M. Fairchild May 22, 1944"
4 3	3			William	A.	Miller		1893-11-15	2/17/1960	
4 3	4			Eva	Ocel	Miller		1895-06-28	1/21/1994	
4 3	5			Billy	Joe	Mansell		6/28/1955	6/29/1955	
4 3	6			Richard	F.	Miller		1898-08-14	10/28/1969	
4 3	7			Ethelena		Miller		1/21/1903		
4 3	8			Timothy	H.	Haley		1887-01-01	7/27/1967	
4 3	9			Lena	A.	Haley		1889-04-19	12/19/1972	
4 3	10			Hattie	C.	Powell Crittenden		11/8/1906		
4 3	11			James	Pinky	Crittendon		1879-06-08	2/27/1953	
4 3	12			Dave	I.	Strader		9/5/1904	10/30/1983	"Married Lena B. Strader Jan 16, 1927"
4 3	13			Lena	B.	Strader		9/25/1911		"Married Timothy H. Strader Jan 16, 1927"
4 3	14			Carolyn	Sue	Strader		2/4/1947	9/6/1972	Daughter of L.C. and Thelma Strader
4 3	15			Harve	A.	Strader		1877-07-25	9/20/1953	
4 3	16			Nora	M.	Strader		1887-12-25	9/8/1954	
4 3	17			Alice	Annie Ables	Thomason		1882-02-28	3/8/1967	
4 3	18			Hettie		Johnson		1889-04-12	2/12/1966	"Married Ellis Johnson; Mother of Nancy Ann, Oren, and Robert."
4 3	19			Ellis		Johnson		1882-09-15	5/31/1951	"Married Hettie Johnson; Father of Nancy Ann, Oren, and Robert."
4 3	20			Ray		Richardson		1898-05-09	9/10/1952	
4 3	21			Mary		Richardson		5/6/1906	11/24/1975	
4 3	22			Clyde	N.	Whitehead		12/15/1901	9/29/1971	
4 3	23			Charles	York	Harper		1876-09-09	9/5/1953	
4 3	24			Cordelia	Gist	Harper		1896-09-21	9/15/1916	
4 3	25			Bety		Tolley		8/7/1934		

*(Continued on page 5)*

(Continued from page 4)

S	R	P	Pre	First	Middle	Last	Suf	DOB	DOD	Comment
4 3 26				Harold		Tolley		7/27/1922	1/4/1986	
4 3 27				Annette	Marie	Tolley		2/25/1957	1/30/1958	Infant of Harold and Betty Tolley
4 3 28				G.	L. "Bud"	Pylant		1873-03-08	5/16/1953	
4 3 29				Minnie	Lee	Pylant		1874-12-04	6/19/1960	
4 3 30				Chancie	E.	Pylant		1896-09-28	3/19/1961	"AR PVT US Army WWI; Married Macey E. Pylant; Father of Rudy, Billie Fern, Ira, Max, Jack, and Ted"
4 3 31				Macey	E.	Pylant		9/1/1900	8/22/1994	"Married Chancie E. Pylant; Mother of Rudy, Billie Fern, Ira, Max, Jack, and Ted"
4 3 32				George	N.	Lawrence		1871-10-26	5/31/1952	
4 3 33				Nell		Cockrum		1898-06-18		
4 3 34				Z.	C. Dick	Cockrum		1895-10-03	8/19/1951	
4 3 35				Lucille		Hannah		6/18/1921		
4 3 36				Houston		Hannah		11/28/1917	2/2/1975	
4 3 37				James	Hiram	Hannah		1875-05-30	2/23/1969	
4 3 38				Alice	Stewart	Hannah		1879-09-21	5/20/1953	
4 3 39				Betty	Lee	Burton		3/9/1932	5/9/1950	
4 3 40				Ira	T.	Dean		1/21/1909	3/13/1974	"Married Irene B. Dean; Father of Ken, Rosie, and Pat."
4 3 41				Irene	B.	Dean		8/10/1915	4/24/1974	"Married Ira T. Dean; Mother of Ken, Rosie, and Pat."
4 3 42				James	F.	Fielder		1897-09-09	9/14/1953	
4 3 43				Ella	May	Fielder		1897-06-13	1/21/1950	
4 3 44				Mildred	Elaine	Greer		2/4/1917	6/4/1979	Daughter of John and Maude Greer
4 3 45				John		Greer		1856-04-09	8/3/1954	
4 3 46				Maude		Greer		1877-10-07	6/4/1957	
4 3 47				Andy		Leabold		1889-10-06	6/25/1947	
4 3 48				Mary	Ellen	Leabold		1892-03-28	5/7/1977	
4 3 49				Frederick	W.	Leabold		12/9/1915	7/3/1947	MO PVT Engineers WWII; son of Andy and Mary Ellen Leabold
4 3 50				Kimble	W.	Franz		1/30/1902	2/10/1985	
4 3 51				Pearl	E.	Franz		1/1/1909	1/8/1978	
4 3 52				Paul	C.	Stroud		9/21/1923	2/15/1982	"Father of David, John, and Tricia"
4 3 53				Georgia	V.	Stroude-Lee		7/3/1904	9/9/1981	Mother of Betty McCann and Paul C. Stroud
4 3 54				Charley	P.	Franz		1867-01-27	12/23/1947	
4 3 55				James	Russell	Burcham		1877-03-04	12/2/1974	
4 3 56				Amy	Bell	Burcham		1884-12-11	2/18/1971	
4 3 57				Herbert	L.	Highfill		6/22/1916		Married Sunshine Highfill; father of Sandra and Jerry
4 3 58				Sunshine		Highfill		7/12/1915	7/21/1994	Married Herbert L. Highfill; Mother of Sandra and Jerry
4 3 59				Jimmie	Andy	Bishop		11/4/1934	7/31/1990	Married Vanetta Mae Bishop; Father of James F. and Kimberly A.
4 3 60				Vanetta	Mae	Bishop		5/30/1936		Married Jimmie Andy Bishop; Mother of James F. and Kimberly A.
4 3 61				James	Franklin	Bishop		1870-12-14	5/5/1954	
4 3 62				Mandy	Rosella	Bishop		1880-02-04	2/21/1954	
4 4 1				George	W.	Taylor		1882-09-14	1/17/1955	MO PVT CO E 313 Ammunition TN WWI
4 4 2				N.	O. Mac	McClarty		1885-05-22	4/28/1955	
4 4 3				Curtis	Mae	McClarty		1899-03-14	7/20/1975	
4 4 4				Wiley	Boyd	Yeargain		3/14/1909	3/11/1959	
4 4 5				Gearney	Lynn	Yeargain		9/20/1955	1/5/1956	
4 4 6				Gene		Strader		6/29/1917	7/9/1975	

(Continued on page 6)

**The Summitt Family Quarterly**

*(Continued from page 5)*

<b>S</b>	<b>R</b>	<b>P</b>	<b>Pre</b>	<b>First</b>	<b>Middle</b>	<b>Last</b>	<b>Suf</b>	<b>DOB</b>	<b>DOD</b>	<b>Comment</b>
4 4	7			Chloe		Strader		3/20/1918	1/24/1978	
4 4	8			Randy	Lee Fuzz	Smith		11/25/1955	6/18/1991	
4 4	9			Ella	Mae	Cato-Jarrett		7/9/1928	6/8/1986	
4 4	10			Richard	Lee	Cato		1898-11-06	12/6/1965	
4 4	11			Esther	Emma	Cato		3/10/1908	12/21/1989	
4 4	12			Rodney	D.	Carmack		2/22/1918	5/13/1971	MO Tec 4 443 SIG HV Const BN WWII
4 4	13			Leona		Mize		1879-10-31	7/11/1956	
4 4	14			Emma		Mize		1897-11-11	9/30/1989	
4 4	15			A.	L. Short	Mize		1896-01-02	6/1/1954	
4 4	16			Bell	Zora	Lambert		1878-05-15	10/11/1954	
4 4	17			Clara	Crow	Lambert		3/3/1914		Mother of Sue Helen, Bradley, Angie, and Amy
4 4	18			Dexter	B.	Lambert		11/17/1911	9/16/1983	Father of Sue Helen, Bradley, Angie, and Amy
4 4	19			Enis		Brannan		4/3/1923		
4 4	20			Lois		Brannan		1/27/1924	4/1/1987	
4 4	21			William	Rufus	Powell		7/14/1912	4/10/1991	
4 4	22			William	W.	Powell		1884-08-12	5/16/1964	
4 4	23			Flossie		Powell		1893-05-07	5/1/1958	
4 4	24			Anna	Mae	Powell		5/12/1918	3/22/1955	Daughter of William W. and Flossie Powell
4 4	25			John	L.	Lofton		1880-12-05	8/9/1957	
4 4	26			Sarah	C.	Lofton		1884-03-28	1/5/1953	NULL
4 4	27			Corrine		Bommersheim		1923	1990	No Headstone
4 4	28			Samual	V.	Tucker		1873-03-06	12/16/1952	
4 4	29			Cecil	Thomas	Lipper		4/21/1913	1/24/1982	
4 4	30			Sam	L.	Lipper		1885-07-28	11/5/1962	
4 4	31			Martha	L.	Lipper		1889-01-11	2/1/1967	
4 4	32			Billie	Wayne	Lipper		5/15/1943	12/31/1956	Son of Mr. & Mrs. Virgil R. Lipper
4 4	33			Virgil	R.	Lipper				
4 4	34			Christine	M.	Lipper		10/28/1924	11/14/1952	
4 4	35			S.	Edgar Bo	Lancaster		1891-01-17	7/25/1975	
4 4	36			M.	Ethel	Lancaster		3/22/1901	10/17/1993	
4 4	39			Stephen	Wayne	Horne		2/2/1952		Son of Mr. & Mrs. Doyle Horne
4 4	40			John	T.	Burton			8/19/1936	
4 4	41			Eva	L.	Payne		2/14/1908	4/11/1986	
4 4	42			Claude	A.	Sando		2/15/1902	10/7/1959	
4 4	43			Pearl		Todd		3/9/1910	3/30/1950	Wife of Claude Sando
4 4	44			Joe	Mack	Sando		10/20/1928	4/30/1968	US Army, Father of Joe Donald and Barry Mack
4 4	45			W.	T. Buster	Barrett		5/12/1902	12/31/1975	Married Alma Greer Barrett, Father of Marlin, Ernest, Nelva, Charles, and Louise
4 4	46			Alma	Greer	Barrett		10/30/1903		Married W. T. "Buster" Barrett, Mother of Marlin, Ernest, Nelva, Charles, and Louise
4 4	47			Luther		Pounds		11/21/1908	10/4/1960	
4 4	48			Myrtle	I.	Pounds		1883-07-08	5/18/1951	
4 4	49			John	C.	Pounds		1872-09-11	8/18/1947	
4 4	50			Sally		Nime		1863-11-17	2/23/1957	
4 4	51			Ada		Buck		1891-12-30	1/13/1963	
4 4	52			Riller	Pearl	Credille		1881	1951	
4 4	53			Hirum	V.	Credille		1878-05-08	11/30/1945	
4 4	54			Roy	Trumann	Shirley		4/12/1907	11/20/1945	Son of Jack and Belle Shirley
4 4	55			Julie	Jones	Bishop		12/14/1905	9/9/1986	Married Marcus K. Bishop, Mother of Carolyn Sue Cobbs, Grandmother of Julie Ann Cobbs and Mark Byron Cobbs.
4 4	56			Marcus	K.	Bishop		5/26/1910	9/15/1987	Married Julie Jones Bishop, Father of Carolyn Sue Cobbs, Grandfather of Julie Ann Cobbs and Mark Byron Cobbs.

*(Continued on page 7)*

(Continued from page 2)

much of the newsletter discussing people that have nothing to do with our immediate family. Seems like I can't win for loosing with those two. I just smile and agree and tell them I will try to do better.

I've heard from several researchers lately. Kim Joyce is researching Catherine Link's lines. Catherine Link first married Christian Summit. She descends from Catherine's brother John through their father Jacob Link. Kim contacted me about a back issue.

David Noland is currently researching his connection to Jacob Sammet and has been in contact with me concerning back issues of the quarterly also.

Ron Thornburgh contacted me concerning the Throneburgs and Thornburgs of North Carolina saying he could add to our research and hoping that we could help with his. He says he has circumstantial evidence that we are connected by David Thornbury b. abt. 1781 in Guilford or Orange County, N.C. He needs an exact birthdate and location and any other information about this subject if anyone can help him.

What he provided us was Mathias Miller Throneburg, Jonathan Throneburg, and A.Miles were brothers to Marcus Augustus Thornburg. As we all know, census takers messed up the family names, Throneburg and Sammet just to name two. These four men also had several sisters but Ron was unable to provide explicit data during our brief conversation. What he did provide was that one sister was Louisa. Ron says he has the entire collection of Mathias Miller Throneburg family, A.Miles and his will, Marcus Augustus and Jonathan's families and I hope to talk him into providing this data for a future issue of the newsletter.

It has been a wonderful ten years publishing and editing this newsletter but I feel that someone else needs to take the helm starting with the April 2005 issue. As a

(Continued on page 15)

(Continued from page 6)

S	R	P	Pre	First	Middle	Last	Suf	DOB	DOD	Comment
4	4	57	Carma	Arthur		Vaughn		1895-11-12	11/10/1984	Married Eva A. Bishop Vaughn July 19, 1919, father of Neva, Eulas, Gene, Thomas, and James
4	4	58	Eva A.	Bishop		Vaughn		12/24/1904		Married Carma Arthur Vaughn July 19, 1919, mother of Neva, Eulas, Gene, Thomas, and James
4	5	1	Jennie	Sue		Conrad		6/8/1918		Married Orville Henry Conrad, mother of Anthony Gene Conrad
4	5	2	Orville	Henry		Conrad		2/27/1911	7/29/1969	Married Jennie Sue Conrad, Father of Anthony Gene Conrad
4	5	3	Anthony	Gene		Conrad		1/2/1955	3/29/1971	son of Orville Henry and Jennie Sue Conrad
4	5	4	James	Walter		Gist		1876-09-19	4/2/1956	
4	5	5	Buford	NULL		Gist		3/14/1911	3/19/1981	
4	5	6	Edna	Mae		Gist		1/27/1914		
4	5	7	Jackie	Gordon		Gist		3/29/1952	3/16/1955	son of Mr. and Mrs Buford Gist
4	5	8	Sidney	Booth		Hays		1889-02-01	9/19/1970	
4	5	9	Ida	Elizabeth		Hays		1894-01-28	9/19/1970	
4	5	10	John	Henry		Carter		1875-04-15	1/4/1961	
4	5	11	Martha	Jane		Carter		1880-12-12	9/3/1955	
4	5	12	Roy	C.		Yeargain		1898-09-22	6/14/1957	Husband of Ethel M. Yeargain, Father of Roy C. Jr., Clayborn, Bill, Ronald, Della Mae, Ruth, Mary, Carolyn, and Joan
4	5	13	Ethel	M.		Yeargain		2/6/1905	6/22/1980	wife of Roy C. Yeargain, mother of Roy C. Jr., Clayborn, Bill, Ronald, Della Mae, Ruth, Mary, Carolyn, and Joan
4	5	14	Daniel			Miller		4/20/1901	3/6/1970	
4	5	15	Stella	May		Miller		6/25/1905	1/6/1994	
4	5	16	Chester	Mack		Washington		11/16/1921	5/21/1992	TEC 5 US Army WWII
4	5	17	Uldene			Washington		12/24/1922		
4	5	18	Hala	A.		Stoker		1890-12-19	5/5/1967	
4	5	19	Coy	C.		Stoker		1889-06-05	6/17/1961	
4	5	20	Vera	Ellen		Lockard		Clark 1898-08-25	10/18/1975	
4	5	21	William	Clay		Clark		1896-09-20	10/10/1959	AR PVT Engineers WWI
4	5	22	Mary	E.		Bonds		1889-01-16	11/1/1974	
4	5	23	James	O.		Bonds		1889-09-02	5/3/1971	
4	5	24	Johnnie	Dale		Loftin		9/20/1935	6/6/1982	
4	5	25	R.	Edna		Loftin		7/9/1915		Wife of Roy A. Loftin, mother of Louise, June, Donnie, and Johnny
4	5	26	Roy	A.		Loftin		10/13/1909	8/13/1969	Husband of R. Edna. Loftin, Father of Louise, June, Donnie, and Johnny
4	5	27	Rosanne			Loftin		3/17/1953	3/17/1953	daughter of Mr. and Mrs. Ralph Loftin
4	5	28	G.	R. Coke	Brewer			7/31/1912	9/26/1976	

(Continued on page 9)





(Continued from page 7)

S	R	P	Pre First	Middle	Last	Suf	DOB	DOD	Comment
4 5 29			Lura	Dempsey	Brewer		12/14/1913		
4 5 30			William	Elbert	Brewer		10/14/1903	3/2/1952	
4 5 31			Bland	S.	Stewart		3/13/1923	3/31/1961	MO S1 US Navy WWII
4 5 32			Thomas	J.	Drope		1873-03-17	3/31/1961	
4 5 33			Jesse	M.	Green		10/19/1927	9/16/1949	MO TEC 5 US Army WWII
4 5 34			Oscar		Green		1902	1955	
4 5 35			Lola		Green		1903		
4 5 36			Edgar	E.	Green		1876-02-24	3/9/1958	
4 5 37			Mary	E.	Green		1877-01-28	10/4/1957	
4 5 38			Margaret	Mae	Wilborn		9/4/1947	9/4/1947	Daughter of Ralph and Cona Wilborn
4 5 39			Becky	Seaborn	Hickman		2/6/19075/11/1985		
4 5 40			John	Montgomery	Seaborn		1864-04-19	2/14/1956	
4 5 41			Sarah	Eugenia	Seaborn		1873-02-27	8/30/1948	
4 5 42			James		Williams		7/1/1928	2/16/1952	
4 5 43			Margaret		Williams		1905	1945	
4 5 44			Claud		Williams		1899		
4 5 45			Mildred	W.	Rorie		4/4/1931	4/26/1980	
4 5 46			Delia		Pope		6/26/1904	4/26/1992	
4 5 47			Garl		Pope		7/16/1908	8/23/1975	
4 5 48			Dora	Ellen	Pope		1879-08-01	3/29/1946	
4 5 49			William	Elbert	Pope		1877-11-13	1/19/1943	
4 5 50			Ellis	Lee	McClearn		9/9/1910	2/15/1978	PFC US ARMY WWII
4 5 51			Roy		McClearn		1888-07-26	12/1/1972	Father of Ellis Lee and Marie
4 5 52			Dortha		McClearn		1889-01-09	12/29/1942	
4 5 53			Billie	Jean	Bishop		3/30/1928	11/6/1953	
4 5 54			O.	U. Bill	Bishop		7/6/1908	1/30/1983	Married Hazel R. Bishop, Father of Billie, Betty, Savannah, and James
4 5 55			Hazel	R.	Bishop		9/28/1908		Married O.U.. Bishop, Mother of Billie, Betty, Savannah, and James
4 5 56			Dee	Frank	Bishop		2/14/1901	11/5/1972	
4 5 57			Nannie	Lu	Bishop		11/17/1905		
4 6 1			James	F.	Edwards		1898-10-08	6/15/1979	
4 6 2			Ora	E.	Edwards		1/28/1900	1/8/1987	
4 6 3			James	A.	Edwards		1/30/1919	4/25/1991	
4 6 4			Ersel		Edwards		10/16/1928		
4 6 5			Bell		Arnold		1888-03-25		
4 6 6			Ed		Arnold		1876-01-15	9/7/1963	
4 6 7			Louie	L.	Blevins		8/22/1909	2/12/1977	
4 6 8			Marie		Blevins		4/9/1913		
4 6 9			Francis	Logan	Short		1885-08-25	11/2/1966	
4 6 10			Jessie	May	Short		1896-03-08	3/2/1967	
4 6 11			Myrtle	Bell	Harrison		1889-06-02	11/1/1967	
4 6 12			William	F.	Harrison		1886-02-12	1/27/1971	
4 6 13			Jennell		Harrison Onley		7/6/1915		
4 6 14			Aubrey	D.	Goodwin		2/11/1910	11/30/1981	
4 6 15			Bonnie	B.	Goodwin		2/14/1910		
4 6 16			Perry	P.	Carter		2/20/1910	11/27/1971	Husband of Gladys E. Carter, father of Kenneth G. Carter
4 6 17			Gladys	E.	Carter		7/6/1914		Wife of Perry P. Carter, mother of Kenneth G. Carter
4 6 18			Barbara	Sue	Jackson		12/6/1979	12/6/1979	
4 6 19			Hershel	Clayborn	Yeargain		11/3/1926	9/30/1989	
4 6 20			Peggy	Elaine	Yeargain		2/9/1967	8/7/1968	
4 6 21			Effie	Lee	Busby		12/31/1906	4/26/1991	
4 6 22			John	W.	Busby		1894-11-15	3/19/1959	

(Continued on page 10)

(Continued from page 9)

S R P	Pre First	Middle	Last	Suf	DOB	DOD	Comment
4 6 23	Carolyn Sue		Followell		12/31/1957	5/30/1958	Daughter of Mr. & Mrs. Virgle Followell
4 6 24	Carlos A.		Woolridge		11/3/1902	4/8/1985	
4 6 25	Ruby Mae		Woolridge		12/1/1908	7/7/1970	
4 6 26	M					9/3/1987	No Headstone
4 6 27	Gladys E.		Tolley		1892-11-16	5/21/1965	
4 6 28	James William		Jones		8/17/1917	12/3/1983	
4 6 29	Susie Anna		Jones		9/10/1914	6/30/1969	
4 6 30	Barney Thomas		Jones		2/25/1946	7/18/1960	Son of Mr. & Mrs. James Jones
4 6 31	J. W.		Denton		1889-01-21	2/8/1968	married Reba Denton April 18, 1920
4 6 32	Reba		Denton		1896-04-12	1/2/1985	Married J.W. Denton April 18, 1920
4 6 33	Kathy Darlene		Lofton		6/6/1956	6/7/1956	
4 6 34	Maudie May		Buchanan		11/12/1907	9/13/1973	
4 6 35	Elmer Eldo		Buchanan		1882-10-01	11/10/1957	
4 6 36	Dave T.		Rhew		1879-07-24	5/21/1957	
4 6 37	Ossie E.		Rhew		1898-01-10	1/6/1985	
4 6 38	Esco E.		Hatcher		1882-10-08	8/1/1956	
4 6 39	Lillie E.		Hatcher		1890-10-03	4/4/1957	
4 6 40	Eva M.		Dubar		1892-10-03	4/8/1978	
4 6 41	Tom		Dubar		1891-07-17	7/13/1956	MO PFC 342 Field ARTY 89 DIV WWI
4 6 42	Edwin E. Ted		Stewart		2/27/1910	10/2/1988	
4 6 43	Eathel A.		Stewart		5/14/1921		
4 6 44	James A.		Stewart		1881-01-04	4/29/1956	
4 6 45	(infant)		Brewer		8/23/1981	8/23/1981	
4 6 46	Bland S.		Stewart		1923	1972	
4 6 47	Thula		Stewart		1890-11-16	12/29/1967	
4 6 48	Edgar		Stewart		1884-09-13	7/7/1950	
4 6 49	Ada		Graham		1880-07-01	11/8/1967	
4 6 50	Otha L.		Wood		1/28/1918	3/27/1950	Michigan Sgt 2133 AAF Base Unit WWII
4 6 51	John Thomas		Wood		1873-12-01	7/5/1957	
4 6 52	Ida		Wood		1875-07-14	10/3/1968	
4 6 53	John H.		Sparks		1903	1975	PVT US ARMY
4 6 54	M. L.		S.				
4 6 55	Mattie Lorean		Sparks		7/23/1910	1/22/1948	
4 6 56	Eli		Woods		3/21/1936	11/26/1952	
4 6 57	Billy Jon		Woods		3/21/1936	5/23/1993	
4 6 58	Wilhelmina		Cook		1871-01-21	9/1/1947	
4 6 59	D. A.		Bradley		1861-12-01	1/16/1946	
4 6 60	Infant		Williams		8/8/1989	8/8/1989	Daughter of Chris and Regina
4 6 61	C. V. Dill		Smith		8/31/1901	7/17/1954	
4 6 62	Minnie Ann		Smith		1873-02-12	12/19/1957	
4 6 63	Hubert		Smith		1897-10-25	5/19/1985	
4 6 64	William E.		Dunigan		10/16/1909	4/22/1955	
4 6 65	Hugh Michael		Dunigan		7/5/1944	7/5/1944	Son of Harry and Laverne Dunigan
4 6 66	Amos H.		Dunigan		1881-05-21	4/21/1955	
4 6 67	Eliza Jane		Dunigan		1883-04-16	10/6/1951	
4 6 68	Doc		McClearn		1891	1974	Father of Earl, Toss, Eula, Bid, Leo, Junita, Mae, Mary, Billie, and Brenda
4 6 69	Blanche		McClearn		1902	1989	Mother of Earl, Toss, Eula, Bid, Leo, Junita, Mae, Mary, Billie, and Brenda
4 6 70	Thomas Carl		Barnett		4/12/1916	1/9/1970	
4 6 71	Annie Smith		Bishop		9/6/1903		Mother of Chloe, Wanda, John, Agnes, Jim, Barbara, and Joann
4 6 72	Van R.		Bishop		1897	1942	
4 7 1	J. F.		Lee		9/26/1924	7/17/1990	S1 US Navy - Married Wanda L. Lee Oct 24, S

(Continued on page 11)

(Continued from page 10)

<b>R</b>	<b>P</b>	<b>Pre</b>	<b>First</b>	<b>Middle</b>	<b>Last</b>	<b>Suf</b>	<b>DOB</b>	<b>DOD</b>	<b>Comment</b>
4 7 2		Wanda	L.		Lee		9/13/1930		1950 - Father of Debra Jane Married J.F. Lee Oct 24, 1950 - Mother of Debra Jane
4 7 3		L.	S.		Shrum		1878-08-08		
4 7 4		Rosa	Wadell		Shrum		7/20/1906		
4 7 5		Arthur	Alexander		Brant		6/8/1919	10/26/1969	NY CWO HQ BTRY 933 FA BN WWII and Korea - Father of Billy Gene and Julia Ann
4 7 6		Anna	Evelyn	Bishop	Brant		11/16/1921	1/16/1990	TEC 5 US Army WWII - Mother of Billy Gene and Julia Ann
4 7 7		C.	W. Dub		Bishop		4/12/1919	12/20/1991	Married Alma F. Bishop April 18, 1942 Father of Crolyn and Sheila - Grandfather of Scott, Bryan, Brittany, and Meagan
4 7 8		Alma	F.		Bishop		11/7/1925		Married C.W. Dub Bishop April 18, 1942 - Mother of Carolyn and Sheila - Grandmother of Scott, Bryan, Brittany, and Meagan
4 7 9		J.	W.		Bonds		5/21/1923	10/6/1968	
4 7 10		James	E.		Clark		1/24/1907	4/12/1970	
4 7 11		Beulah	M.		Clark		2/5/1910	3/28/1991	
4 7 12		J.	W.		Francway		3/6/1932	10/20/1982	SR US Navy Korea
4 7 13		Lizzie	M.		Fancway		1890-04-19	9/27/1976	
4 7 14		Willie	Lee		Francway		1885-03-09	6/27/1958	Father of Henry, Robert, Ernest, John, Dellie, Emma, and Blanche
4 7 15		Jerry	A.		Foster		8/16/1932	2/19/1980	
4 7 16		Bobby	Joe		Foster		11/11/1937	11/19/1979	
4 7 17		Zadie	Cordie		Foster		10/25/1904	10/13/1973	
4 7 18		Joe	Henry		Foster		1894-02-21	2/14/1964	MO PVT CO C 322 Infantry WWI
4 7 19		Marvin	W.		Wood		10/29/1912	6/25/1990	
4 7 20		Luereine			Wood		3/28/1918		
4 7 21		Grover	T.		Stewart		7/14/1919		
4 7 22		Reba	Wood		Stewart		6/21/1921		
4 7 23		Elsie	Mary		Sissom		1/28/1909	11/29/1985	Married Andy Daniel Sissom Dec 23, 1925 - Mother of Edward W., Andy D. Jr., Betty L., Marvin Joe, Tollie C., Margaret D., Frank E., Norma J., and Kenneth L.
4 7 24		Audy	Daniel		Sissom		1/22/1906	5/11/1976	Married Elsie Mary Sissom Dec 23, 1925 - Father of Edward W., Audy D. Jr., Betty L., Marvin Joe, Tollie C., Margaret D., Frank E., Norma J., and Kenneth L.
4 7 25		James	C.		Queen		1884-08-20	1867-07-24	
4 7 26		Margie	Lee		Queen		1891-12-02	11/24/1956	
4 7 27							1/28/1928	12/19/1983	
4 7 28		James	Lee		Higlen		6/18/1918	3/12/1984	
4 7 29		Patricia	Jean		Higlen		9/13/1918	12/26/1980	
4 7 30		Lela			Higlen		9/19/1900	12/19/1970	
4 7 31		Joseph			Higlen		1887-09-17	9/11/1961	
4 7 32		Franklin D.			Higlen		2/13/1933	1/28/1956	Son of Joseph and Lela Higlen
4 7 33		Lindell	Lindy Troy		Chilton		9/12/1960	6/23/1974	Son of Lindell and Wilma Chilton, Brother of Sherry and David
4 7 34		Cullie	F.		Branum		1/2/1904	11/27/1980	
4 7 35		Clola	M.		Branum		2/14/1908	4/28/1992	

(Continued on page 12)

(Continued from page 11)

S R P	Pre	First	Middle	Last	Suf	DOB	DOD	Comment
4 7 36	NO			HEADSTONE				
4 7 37	Charles	S.		Johnson		1896-08-29	12/17/1953	TN STAB SGT 164 Infantry WWI
4 7 38	Luttie	M.		Taylor		1892-05-07	8/9/1965	
4 7 39	James	A.		Taylor		1890-05-02	7/17/1969	
4 7 40	Newt	H.		Taylor		1897-07-05	11/4/1953	
4 7 41	H. Hub	H.		Higgins		9/5/1913	6/27/1973	
4 7 42	Bertha	Mae		Higgins		1/14/1917	7/30/1948	
4 7 43	Patty	Rhea		Crow		12/20/1946	12/29/1946	
4 7 44	Syntha	J.		Tille		1876-09-03	9/2/1948	
4 7 45	John	W.		Morgan		1864-05-17	5/5/1947	
4 7 46	Jessie	S.		Jones		10/17/1904	6/9/1986	Married Becky Elliott Jones Sept 23, 1933 - Father of John, Jerry, Lonnie, Dewayne, and Jessie
4 7 47	Beckie	Elliott		Jones		3/10/1915		Married Jessie S. Jones Sept 23, 1933 - Mother of John, Jerry, Lonnie, Dewayne, and Jessie
4 7 48	John	D.		Holcomb		1890-07-08	4/6/1949	Father of Onie Purcell and Becky Elliott Jones
4 7 49	Lou	Cole		Holcomb		1886-11-25	3/1/1946	Mother of Onie Purcell and Becky Elliott Jones
4 7 50	Melvin			Phelps		11/27/1926	11/21/1944	
4 7 51	Mary	Johnnie		Nicklson		1911	1980	
4 7 52	Baby			Nelson		9/20/1941	9/20/1941	
4 8 1	Aria	Bell		Bullington		9/17/1904	12/23/1985	Mother of Paul L., James W., Sammie, Wanda, and Winnia
4 8 2	William Franklin			Bullington		1894-03-01	12/10/1964	Father of Paul L., James W., Sammie, Wanda, and Winnia
4 8 3	Winnia	Lou		Busby		10/16/1938		Married Billy Gene Busby July 11, 1964 - Mother of Winni Gene
4 8 4	Billy	Gene		Busby		4/25/1938	9/17/1990	Married Winnia Lou Busby July 11, 1964 - Father of Winni Gene
4 8 5	Mamie	Smith		Montgomery		9/30/1900		
4 8 6	Ernest	Bill		Montgomery		11/26/1903	10/12/1992	
4 8 7	Jack	Fonce		Montgomery		6/7/1930	12/14/1987	PVT US Army - Father of Billy Jack, Jeffery Mark, Karen, & Loree
4 8 8	Julious	Jude Y.		Montgomery		6/23/1906	3/29/1987	PVT US Army WWII
4 8 9	Verna			Montgomery		2/24/1908		Married Julious Montgomery Feb 29, 1929
4 8 10	Gladys			Summitt		12/1/1909		Married Paul Summitt Jan 28, 1920
4 8 11	Paul			Summitt		3/20/1906	9/11/1984	Married Gladys Summitt Jan 27, 1928
4 8 12	Glendola Dell			Harrison		3/31/1920		Maiden Name Summitt - Married Armon Eli Harrison Sept 26, 1940 - Mother of Anna Marie and Linda, Grandmother of David, Kevin, and Bryan
4 8 13	Armon	Eli		Harrison		3/18/1920	9/11/1984	AS US Navy - Married Glenola Dell Summitt Sept 26, 1940 - Father of Anna Marie and Linda, GrandFather of David, Kevin, and Bryan
4 8 14	Phyllis			Frye			2/28/1985	In Loving Memory Carl, Carla, and Carlos
4 8 15	Jack	C.		Fain		1886-04-09	11/2/1967	Married Minnie V. Fain May 4, 1921 Father of Annie Bell, Henry, Virgle, Bill, Lucille, Irene, Mable, Dorothy, Robert, Jerry Don, D.D., and Phyllis
4 8 16	Minnie	V.		Fain		1/5/1904	6/15/1976	Married Jack C. Fain May 4, 1921 Mother of Annie Bell, Henry, Virgle, Bill, Lucille, Irene, Mable, Dorothy, Robert, Jerry Don, D.D., and Phyllis
4 8 17	Franklin	D.D.D.		Fain		1/30/1945	11/26/1965	

(Continued on page 13)

(Continued from page 12)

S	R	P	Pre	First	Middle	Last	Suf	DOB	DOD	Comment
4	8	18		Ethelbert		DeMent		1889-10-09	6/30/1979	Married Syrilda DeMent June 28, 1923 Parent of Verla, James, Gordon, Mildred, Delbert, Chancey, and Eula Jean
4	8	19		Syrilda		DeMent		8/26/1900		Married Ethelbert DeMent June 28, 1923 Parent of Verla, James, Gordon, Mildred, Delbert, Chancey, and Eula Jean
4	8	20		Eugenia G.		Barrett		1878-02-02	7/20/1963	Married A. L. Barrett Sept 10, 1899
4	8	21		A. L.		Barrett		1878-03-01	3/12/1969	Married Eugenia G. Barrett Sept 10, 1899
4	8	22		Elsie	Maybell	Cherry		1898-05-09	8/24/1962	
4	8	23		William	Ernest	Greenwood		1889-09-08	4/1/1962	MS Cook Co M 43 Infantry - Married Vergie Greenwood Nov 12, 1919 - Father of W.Q., Louise, Mary, Lynn, and Frances
4	8	24		Vergie		Greenwood		1898-09-08	6/2/1984	Married William Earnest Greenwood Nov 12, 1919 - mother of W.Q., Louise, Mary, Lynn, and Frances
4	8	25		Lannis	Earl	Wood		1914	1992	
4	8	26		Harvey	D.	Wood		1887-04-08	6/12/1963	
4	8	27		Mamie	B.	Wood		1889-11-07	6/12/1960	
4	8	28		George		Denton		3/10/1921	3/6/1960	
4	8	29		Drucilla	Jane	Gibson		1881-05-10	6/11/1957	
4	8	30		Georgia		Hawks		1889-02-22	11/13/1956	
4	8	31		Lon		Hawks		1887-03-16	1/26/1960	
4	8	32		Mearl	Gail	Dean		10/26/1912		
4	8	33		Blanche	Ida	Dean		11/17/1911	10/26/1982	
4	8	34		Matthew	Franklin	Wilkins		11/8/1962	1/31/1992	Son of Annette Higlen Wilson
4	8	35		Barry	Mark	Wilkins Jr.		3/16/1980	9/21/1980	son of Mark and Teresa Wilkins
4	8	36		Estel	S.	Newson		2/12/1904	12/27/1977	
4	8	37		Ina	Mae	Newson		7/29/1905	6/23/1977	
4	8	38		Jewell	L.	Glenn		11/2/1904	12/22/1992	Mother of J.F., Pauline, Bud, Mary, Virginia, Jim, and Sid CPL US Army
4	8	39		Roy	Amos	Glenn		3/3/1929	11/8/1988	
4	8	40		Amos	C.	Carter		1884-06-22	3/29/1964	
4	8	41		Pearl		Carter		1884-04-22	3/5/1963	
4	8	42		George		Hembrey		3/6/1924	9/27/1993	
4	8	43		Roy	Raymond	Hembrey		8/22/1919	12/20/1988	Son of John F. and Edna M. Hembrey
4	8	44		Edna	M.	Hembrey		5/19/1902		
4	8	45		John	F.	Hembrey		1884-10-20	11/25/1953	
4	8	46		Abraham	B.	Crow		1879-11-13	4/2/1951	
4	8	47		William	H.	England		1868-07-26	3/2/1954	
4	8	48		James	Buel	England		7/18/1923	8/21/1948	MO Staff SGT HO CO Alaskan Dept. WWII
4	8	49		Amos		England		10/5/1900	2/6/1990	
4	8	50		Pearl	Sparks	England		3/21/1902	9/18/1975	
4	8	51		Sarah	Francis A.	Morgan		1881-12-24	12/26/1947	
4	8	52		Florence	G.	Phelps		7/2/1906	1/13/1969	Loving Memory of father and mother, Billy and Freda Phelps
4	8	53		Elmer	L.	Phelps		3/21/1902	4/14/1976	Loving Memory of father and mother, Billy and Freda Phelps
4	8	54		James	D.	Grady		1896-02-20	2/21/1961	MO PFC 313 Engineers WWI
4	8	55		Anna	M.	Grady		12/24/1900	12/27/1943	
4	9	1		Connie	F.	McCaskill		10/30/1908		
4	9	2		David	F.	McCaskill		1896-02-27	1/9/1964	
4	9	3		Susan		Muse		1894-08-18	3/17/1967	
4	9	4		Joel	E.	Muse		1890-09-11	10/21/1976	
4	9	5		Lewis	Carman	Frie		10/24/1914	4/19/1998	Married Iva Glasgow Frie Sept 26, 1931, Father of Ray, Shirley, and Larry

(Continued on page 14)

(Continued from page 13)

S	R	P	Pre	First	Middle	ast	Suf	DOB	DOD	Comment
49	6		Iva	Glasgow	Frie			11/5/1914	8/4/1987	Married Lewis Carman Frie Sept 26, 1931, Mother of Ray, Shirley, and Larry
49	7		Myrtle	Venola	Quinn			3/11/1910	7/12/1993	Mother of Wilbourn, Janetta, Betty, Junior, Nancy, Harvey, Dorthy, and Lucille
49	8		James	Wesley	Barlow			6/19/1924	7/12/1993	PFC US Army WWII
49	9		Ollie		Barlow			8/28/1905	8/11/1994	
49	10		Joe	Edgar	Barlow			12/10/1901	8/26/1966	
49	11		Carlis	E.	Williams			5/16/1922		
49	12		Maxine		Williams			9/13/1924		
49	13		Williard J.		Shatley			10/6/1927	3/30/1964	AR CPL H&S CO 73 ENGR Combat BN Korea
49	14		Howard		Loyd			1890-04-11	11/12/1972	
49	15		Susie		Loyd			1892-05-21	12/20/1963	
49	16		Delbert D.		Flippin			11/7/1900	2/23/1986	
49	17		Larah B.		Flippin			7/1/1900	7/8/1988	
49	18		Dow		Marshall			1896-10-15	5/27/1965	
49	19		Edith		Rollins			11/11/1910	11/30/1992	
49	20		Thomas L.		Rollins			5/22/1904	11/26/1964	
49	21		Amanda E.		Underwood			1871-04-25	9/8/1968	
49	22		Novas B.		Stewart			1/28/1914	5/28/1962	
49	23		Elizabeth	Brandon	Helton			1880-12-04	8/16/1962	
49	24		Thomas	Pink	Helton			1877-02-24	4/6/1962	
49	25		T.	Doyle	Batchelor			6/10/1919	6/1/1994	
49	26		Thomas W.		Forbuss			1890-12-12	1/15/1960	MO PVT BTRY F343 FA 89 DIV WWI
49	27		Icel	Mae	Pierce			4/23/1905	4/11/1989	
49	28		Alvis G.		Pierce			1896-11-16	1/9/1960	PVT D 162 Depot Brigade WWI
49	29		Concrete	Block	No Name					
49	30		Shilah	Marie	Cross			9/16/1989	9/16/1989	Daughter of Rick and Patricia Cross
49	31		Ollie	Macel	Nix			3/8/1936	4/18/1976	
49	32		Louella	Cross	Henragir			4/28/1909	11/14/1990	
49	33		Lewis	Floyce	Cross			10/14/1901	2/22/1957	
49	34		John	W.	Vance			1898-08-03	3/31/1957	
49	35		Gertie	M.	Vance			6/1/1902		
49	36		William G.		Harkey			1898-05-07	4/2/1972	
49	37		Mamie	NULL	Harkey			1895-02-27	2/1/1956	Wife of Bill Harkey
49	38		James	Wesley	Wallace			1880-03-16	6/3/1955	
49	39		Doris	Cox	Wallace			1898-07-06	10/11/1974	
49	40		Byron	G.	Horner			1/8/1918	4/16/1976	SGT US Army WWII
49	41		Carrie	I.	Dees			5/9/1907	4/21/1972	
49	42		Clarence	B.	Dees			3/9/1901	12/3/1955	
49	43		Anna		Jarrett			1889-10-08		
49	44		Marshall	E.	Jarrett			1888-05-26	12/11/1960	
49	45		John	W.	Jarrett			1886	1955	
49	46		Philip	Daily	Harper			4/9/1940	9/19/1973	Father of Philip Jr and Kirby Lynn
49	47		Linda	Joyce	Harper			1/22/1944		
49	48		Daniel	M.	Nolen			1/5/1920	12/10/1993	SGT US Army Air Corps WWII
49	49		Rubin		Nolen			7/16/1913	7/28/1973	
49	50		Frank		Nolen			1878-01-23	6/15/1962	
49	51		Eliza		Nolen			1883-12-03	8/25/1959	
49	52		Leroy	Bert	Smith			11/2/1900	9/19/1962	
49	53		Martin	Benjamin	Smith			6/11/1910	8/24/1987	
49	54		Cora		Smith			2/28/1918	3/31/1985	
49	55		Merle	Mildred	Wells			3/13/1921	8/11/1963	
49	56		Gary		Wells			10/12/1935	12/19/1973	IL SSGT US Air Force Korea & Vietnam
49	57		Sam		Wells			1881-04-18	4/28/1952	
49	58		Maggie	Lee	Wells			1894-12-13	12/26/1979	

(Continued on page 15)

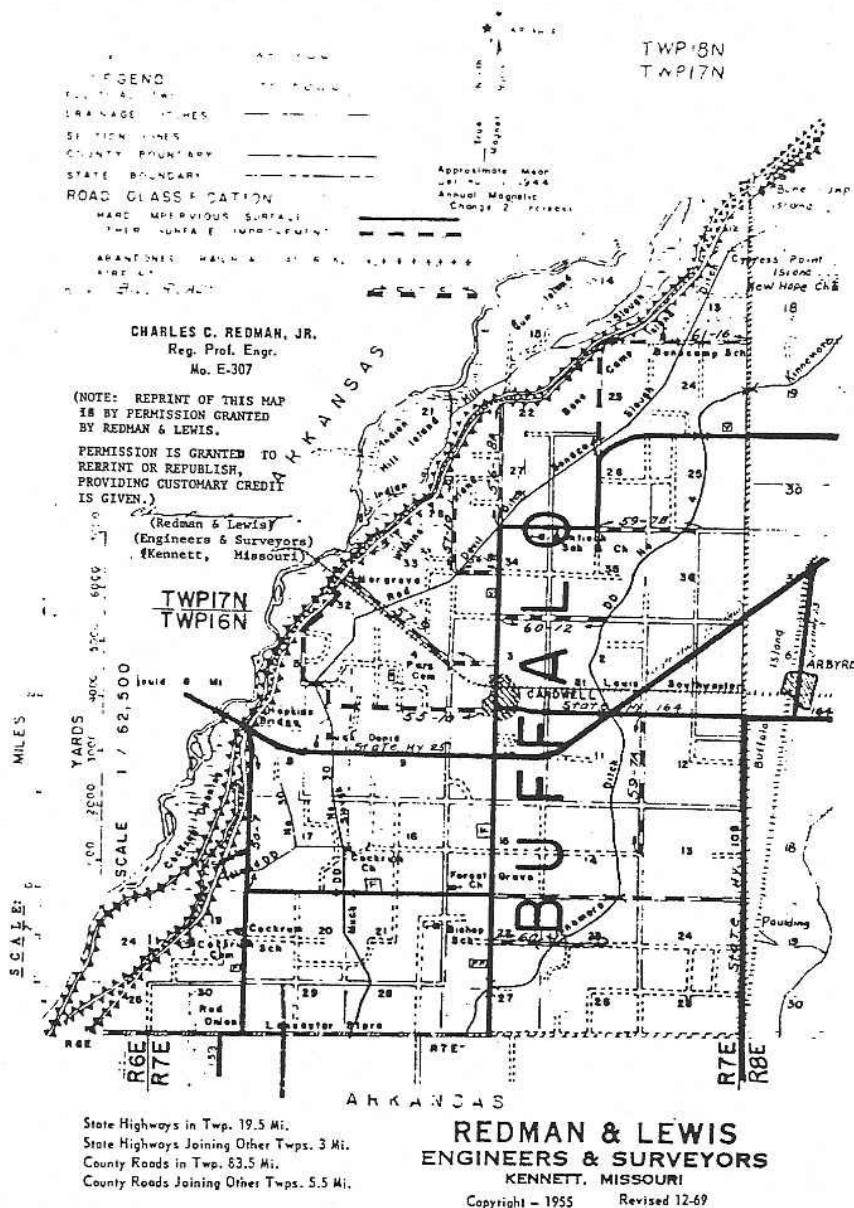

(Continued from page 7)

result we are accepting no new subscriptions and are accepting no payments from current subscribers to extend their subscriptions. All current subscriptions will be extended through the January 2005 issue at no charge. If anyone thinks that their current subscription extends past the January 2005 issue please let me know and we will work out an agreeable reimbursement should no new editor/publisher be found.

I plan on continuing my research into the James Lee Summitt line as well as the Frie, Love, and Spotswood lines and hope to contribute to this quarterly in the future. I also plan to continue working with the SFQ Web site as well as the Cardwell Cemetery project.

So, we are looking for someone interested in taking on this quarterly starting with the April 2005 issue. We will assist in training the new editor/publisher and help with software and hardware selection. Anyone with a home computer, Microsoft Publisher, and Family Tree Maker can be the publisher. I look forward to working with any new editor.

So, those interested, contact me via email at psummitt@summittnewmedia.com or by phone at 573-268-7209.

paul

(Continued from page 14)

S	R	P	Pre	First	Middle	Last	Suf	DOB	DOD	Comment
4 9 59	Robbie	Jean	Faulkner					1925	1943-	
4 9 60	Troy	Cecil	Bishop					11/19/1903	5/26/1972	
4 9 61	Hazel	Bell	Bishop					4/9/1904		
4 9 62	Ruth	A.	Bishop					1868-02-22	8/17/1955	
4 9 63	Roy	J.	Bishop					12/21/1901	5/14/1960	
4 9 64	Nina		Williams					7/7/1903	9/10/1986	Married Bailey Williams Aug 1, 1921 - Mother of Carlis, Estelle, Charles, Juanita, Doyle, Leon, Jerry, and Melvin
4 9 65	Bailey		Williams					8/27/1900	12/16/1985	Married Nina Williams Aug 1, 1921 - Father of Carlis, Estelle, Charles, Juanita, Doyle, Leon, Jerry, and Melvin
4 9 66	Donald	Bailey	Barnes					9/8/1942	2/8/1948	

The Summitt Family  
Quarterly  
312 Proctor Drive  
Columbia, MO 65202

Mailing  
Address  
Goes  
Here

### **In This Issue...**

### The Cardwell Cemetery

Cardwell Missouri map

1930 Census—Dunklin  
County, Missouri

Buffalo Township,  
Missouri